

# Performing Arts Center

[www.depauw.edu/pac](http://www.depauw.edu/pac)

## Technical Information

last revised: April 2004

(For further information, please contact Technical Director)

### **SYNOPSIS**

DePauw University's Performing Arts Center is a multi-level performance and learning facility containing a three-level academic wing as well as a performing arts component which houses four performance halls.

### **PERFORMANCE SPACE SUMMARY**

Kresge Auditorium	1400 seats	Concert Hall (no fly space)	contact Janice Bagwell
Moore Theatre	379 seats	Proscenium Theatre	contact Joyce Christiansen
Thompson Recital Hall	219 seats	Recital Hall (no fly space)	contact Janice Bagwell
Kerr Theatre	80 seats	Black Box (no fly space)	contact Joyce Christiansen

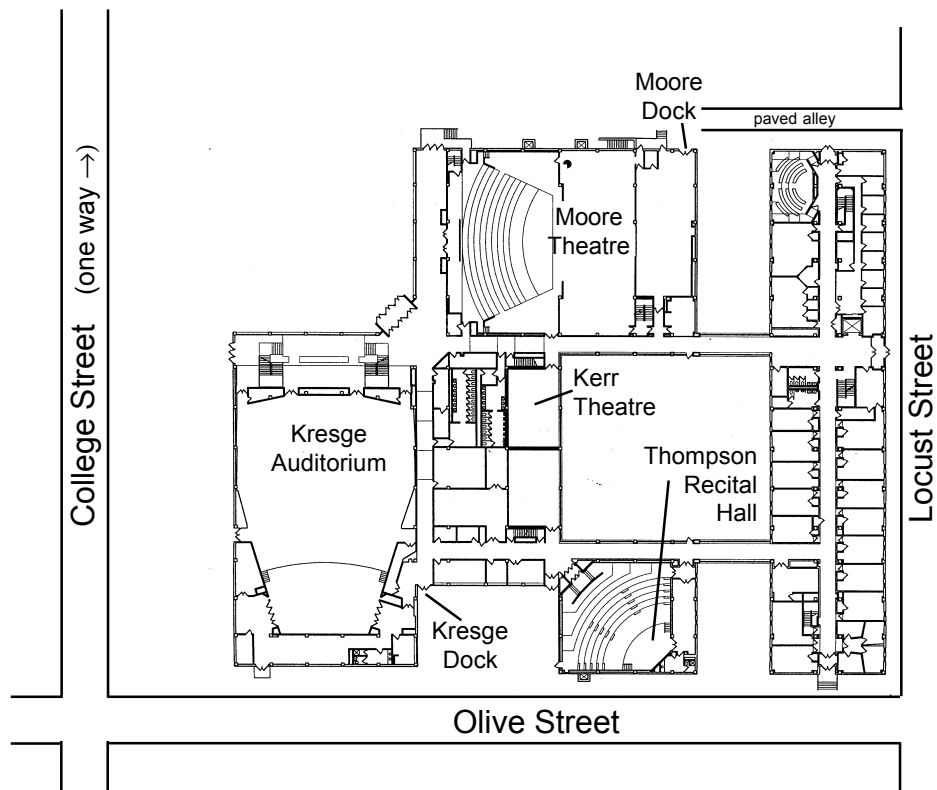

### **OPERATIONS/SCHEDULING STAFF**

<b>G. Duane Skoog — Technical Director:</b> (technical questions and general information)	<a href="mailto:gdskoog@depauw.edu">gdskoog@depauw.edu</a>	(765) 658-4829
<b>Gigi Genewein-Fenlon — Interim Marketing Director:</b> (publicity and marketing questions)	<a href="mailto:gfenlon@depauw.edu">gfenlon@depauw.edu</a>	(765) 658-6508
<b>Janice Bagwell — Concert &amp; F.O.H. Manager:</b> (scheduling of Thompson Recital Hall and Kresge Auditorium, Box Office)	<a href="mailto:jbagwell@depauw.edu">jbagwell@depauw.edu</a>	(765) 658-4379
<b>Joyce Christiansen — Communications Dept Secretary:</b> (scheduling of Moore Theatre and Kerr Theatre)	<a href="mailto:christiansen@depauw.edu">christiansen@depauw.edu</a>	(765) 658-4489

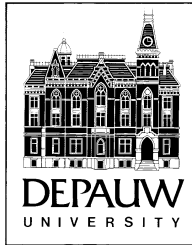

# Performing Arts Center

[www.depauw.edu/pac](http://www.depauw.edu/pac)

## Technical Information

last revised: April 2004

(For further information, please contact Technical Director)

### LOCATION INFORMATION AND DIRECTIONS

DePauw University's campus is located in Greencastle, Indiana, halfway between Terre Haute and Indianapolis on US-231 approximately 10 miles north of I-70.

#### Coming south on US-231 (i.e. from Lafayette):

231 brings you south to the town square, and turns left immediately thereafter onto Washington Street at a stoplight. Follow 231 at that turn and continue five blocks, and turn right onto Locust Street. After four blocks, you will cross Hanna Street (stop sign), and will see the Performing Arts Center on your right (labelled "Burkhart Hall" on the Locust Street side). Thereafter, refer to the map in this document's "Performance Space Summary" to arrive at the appropriate loading dock.

#### Coming north on US-231 (i.e. from Terre Haute or Indianapolis via I-70):

The first stoplight you reach from the south into town is at Veteran's Memorial Highway. Cross it and continue on 231 for four blocks. Turn left onto Hanna Street and continue for four blocks until the stop sign at Locust Street. Turn left onto Locust street and you will see the Performing Arts Center on your right (labelled "Burkhart Hall" on the Locust Street side). Thereafter, refer to the map in this document's "Performance Space Summary" to arrive at the appropriate loading dock.

### LABOR

The PAC relies completely on undergraduate work-study labor for all events, excepting the technical director, marketing director, and respective on-campus promoter (whom could also be a student). Due to students' sporadic class and activity schedules, it is necessary for the TD to receive, well in advance of the company's arrival, a load-in and production schedule, giving **detailed** crew requirements. For example:

7:30am	Company arrival
8am - 12pm	Load-in (2 loaders, 4 stagehands, 3 electricians, 1 wardrobe, 1 runner)
1pm - 2:30pm	Focus (3 electricians)
2:30pm - 4pm	Sound check (2 sound)
6pm	Crew call for show
7pm - 9pm	Performance (3 deck crew, 2 flymen, 1 lightboard op, 1 sound, 2 followspot)
9pm - 11pm	Load-out (6 stagehands)

If absolutely necessary, it is possible to secure IATSE labor from Local #49 in Terre Haute, contingent on the presenter's budget.

### LOCAL MERCHANTS

Greencastle boasts a fair variety of merchants who carry supplies you may need to acquire on the road. Listed are the most frequently requested:

- Wal-Mart Supercenter
- Pat's Ace Hardware
- Headley True Value Hardware
- Black Lumber
- Radio Shack
- Fastenal

The closest *theatrical* supply houses are in Indianapolis and Terre Haute, 45-60 minutes away.

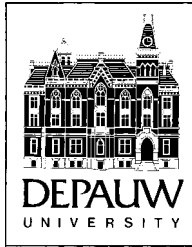

# Performing Arts Center

[www.depauw.edu/pac](http://www.depauw.edu/pac)

## Technical Information

last revised: May 2002

(For further information, please contact Technical Director)

### LOCATION INFORMATION AND DIRECTIONS

DePauw University's campus is located in Greencastle, Indiana, halfway between Terre Haute and Indianapolis on US-231 approximately 10 miles north of I-70.

#### Coming south on US-231 (i.e. from Lafayette):

231 brings you south to the town square, and turns left immediately thereafter onto Washington Street at a stoplight. Follow 231 at that turn and continue five blocks, and turn right onto Locust Street. After four blocks, you will cross Hanna Street (stop sign), and will see the Performing Arts Center on your right (labelled "Burkhart Hall" on the Locust Street side). Thereafter, refer to the map in this document's "Performance Space Summary" to arrive at the appropriate loading dock.

#### Coming north on US-231 (i.e. from Terre Haute or Indianapolis via I-70):

The first stoplight you reach from the south into town is at Veteran's Memorial Highway. Cross it and continue on 231 for four blocks. Turn left onto Hanna Street and continue for four blocks until the stop sign at Locust Street. Turn left onto Locust street and you will see the Performing Arts Center on your right (labelled "Burkhart Hall" on the Locust Street side). Thereafter, refer to the map in this document's "Performance Space Summary" to arrive at the appropriate loading dock.

### LABOR

The PAC relies completely on undergraduate work-study labor for all events, excepting the technical director, marketing director, and respective on-campus promoter (whom could also be a student). Due to students' sporadic class and activity schedules, it is necessary for the TD to receive, well in advance of the company's arrival, a load-in and production schedule, giving **detailed** crew requirements. For example:

7:30am	Company arrival
8am - 12pm	Load-in (2 loaders, 4 stagehands, 3 electricians, 1 wardrobe, 1 runner)
1pm - 2:30pm	Focus (3 electricians)
2:30pm - 4pm	Sound check (2 sound)
6pm	Crew call for show
7pm - 9pm	Performance (3 deck crew, 2 flymen, 1 lightboard op, 1 sound, 2 followspot)
9pm - 11pm	Load-out (6 stagehands)

If absolutely necessary, it is possible to secure IATSE labor from Local #49 in Terre Haute, contingent on the presenter's budget.

### LOCAL MERCHANTS

Greencastle boasts a fair variety of merchants who carry supplies you may need to acquire on the road. Listed are the most frequently requested:

- Wal-Mart Supercenter
- Pat's Ace Hardware
- Headley True Value Hardware
- Black Lumber
- Radio Shack
- Fastenal

The closest *theatrical* supply houses are in Indianapolis and Terre Haute, 45-60 minutes away.

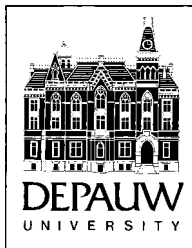

# Kresge Auditorium

[www.depauw.edu/pac](http://www.depauw.edu/pac)

## Technical Information

last revised: Sept 2002

(For further information, please contact Technical Director)

### **SYNOPSIS**

---

Kresge Auditorium is the university's primary concert, convocation, and road-show hall, and seats approximately 1400. It houses a large pipe organ built into one wall of the stage. The hall is acoustically very live, and requires no sound reinforcement for musical concerts. Convocations, lectures, and other road-show events either use the small in-house audio system, or subcontract audio to an outside vendor.

### **STAGE INFORMATION**

---

Type:	Concert Hall (no proscenium or fly space)	
Floor:	Hardwood floor stained blonde and finished with clear polyurethane	
Width:	Wall to Wall (upstage):	44'-9"      13.640 meters
	Wall to Wall (downstage):	64'-8"      18.710 meters
	(permanent organ obstruction downstage left - see drawings)	
Depth:	Apron to upstage wall:	36'-5"      11.125 meters
	Apron to curtain line:	7'      2.134 meters
Height:	House Floor to Stage Floor:	3'-6"      1.067 meters
	Floor to ceiling (upstage):	24'      7.315 meters
	Floor to ceiling (downstage):	28'      8.534 meters

Stage Drawings are available in AutoCad format or on request.

### **RIGGING:**

---

As there is no fly system in this hall, we have the following gear to support minimal flying requirements:

- two 16' hand-crank lifts, 7' footprint
- four 10' sections of 1' triangular trussing
- black chevron borders, legs and panels for same

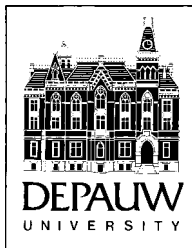

# Kresge Auditorium

[www.depauw.edu/pac](http://www.depauw.edu/pac)

## Technical Information

last revised: Sept 2002

(For further information, please contact Technical Director)

### LOADING/UNLOADING

The loading doors for this hall are located off an inclined paved drive off of Olive Street. They are standard double doors with a removable center post. All gear must be pushed through THREE sets of double doors to reach the stage (outer doors, backstage doors, and onstage doors). Access to FOH can be reached via a ramped hallway to the lobby, or via a ramped hallway to double doors near downstage left at auditorium level.

Usable Width:	5'-10"	1.78 meters
Usable Height:	7'-9"	2.36 meters

### DRESSING ROOMS

There is one dressing room and one green room only, as follows:

#### Dressing Room:

Dimensions:	10'-8" x 6'-4"	3.27m x 1.92m
Amenities:	costume rack, mirrors, counterspace, 2 sinks	
Bathroom:	1 commode, 1 shower	

#### Green Room:

Dimensions:	15'-6" x 8'-1"	4.72m x 2.48m
Amenities:	kitchenette, sofas, costume rack	

### CONTROL BOOTH

The control booth is located at the extreme top and rear of the auditorium, accessed by the main lobby stairs and through the balcony. It is enclosed and has doors at either end. Audio is at house right, lights at house left, and a counter runs the width of the windowed wall. The window in front of the audio section can be opened. The lighting catwalk and ceiling above the stage is accessed through a ladder in the booth.

Distance from apron:	approximately 100' (30.48 meters)
Other Balcony Equipment:	Two Strong Super-Trouper II followspots

### LIGHTING

Lighting Positions:	<u>From Apron</u>	<u># of Circuits</u>
First Cove:	38' (11.58m)	41
Second Cove:	18'-2" (5.52m)	29
Additional Stage:		18 (3-circuit floor pockets) Several constant-hot 110VAC circuits

Dimmers:	288 ETC Sensor 2.4Kw
Patch:	Only soft patch, otherwise dimmer/circuit
Console:	ETC Expression 3 (two monitors) with Remote Focus Unit
Plugs:	All plugs are 2P&G connectors

### LIGHTING INVENTORY

<u>Quantity</u>	<u>Make</u>	<u>Model</u>	<u>Beam</u>	<u>Wattage</u>	<u>Lamp</u>
30	ETC	Source Four	19	575W	HPL
2	Strong	Super Trouper II follow spots			

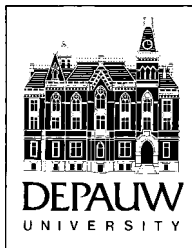

# Kresge Auditorium

[www.depauw.edu/pac](http://www.depauw.edu/pac)

## Technical Information

last revised: Sept 2002

(For further information, please contact Technical Director)

### **SOUND INVENTORY**

---

- 1 Yamaha MX200 mixer, stereo and mono masters, 4 aux buses (2 pre, 2 post)  
Master faders used to feed recording decks and other equipment,  
while PA system is fed by Auxiliary buses
- 2 Mackie M-1200 power amps, which feed 1/4" jacks on stage
- 1 Teac CD-P1440 single tray CD Player
- 1 Sony PCM-R300 DAT recorder
- 1 DBX 166A compressor/limiter
- 1 Tascam 112 mkII cassette recorder
- 1 Behringer GEQ3102 dual 31-band EQ
- 2 Technomad Noho full-range speakers
- 2 JBL MP418SP powered subwoofers
- 2 Klipsch monitor wedges
- 2 EV monitor wedges (small, 12" woofers)
- 6 mic channels to stage jacks
- 1 snake to stage with 8 channels, 4 returns
- 4 Audio-Technica 7000 series wireless systems (each with either handheld or belt-pack)
- 4 Direct Input boxes (two active, two passive)
- 4 Shure SM58
- 4 Shure SM57
- 4 Neumann KM-84

### **INTERCOM**

---

- 1 Clear-comm intercom base station
- 5 belt-pack/headset combos normally in theatre, can scavenge from other halls if more are needed
- 7 intercom jacks throughout backstage, house, booth, and balcony

### **POWER**

---

- 1 3-phase disconnect, 400 amps/leg
- 1 3-phase disconnect, 200 amps/leg  
both disconnects located backstage left and require bare-lead tails, tied in by PAC or DePauw staff

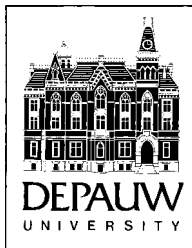

# Kresge Auditorium

[www.depauw.edu/pac](http://www.depauw.edu/pac)

## Technical Information

last revised: Sept 2002

(For further information, please contact Technical Director)

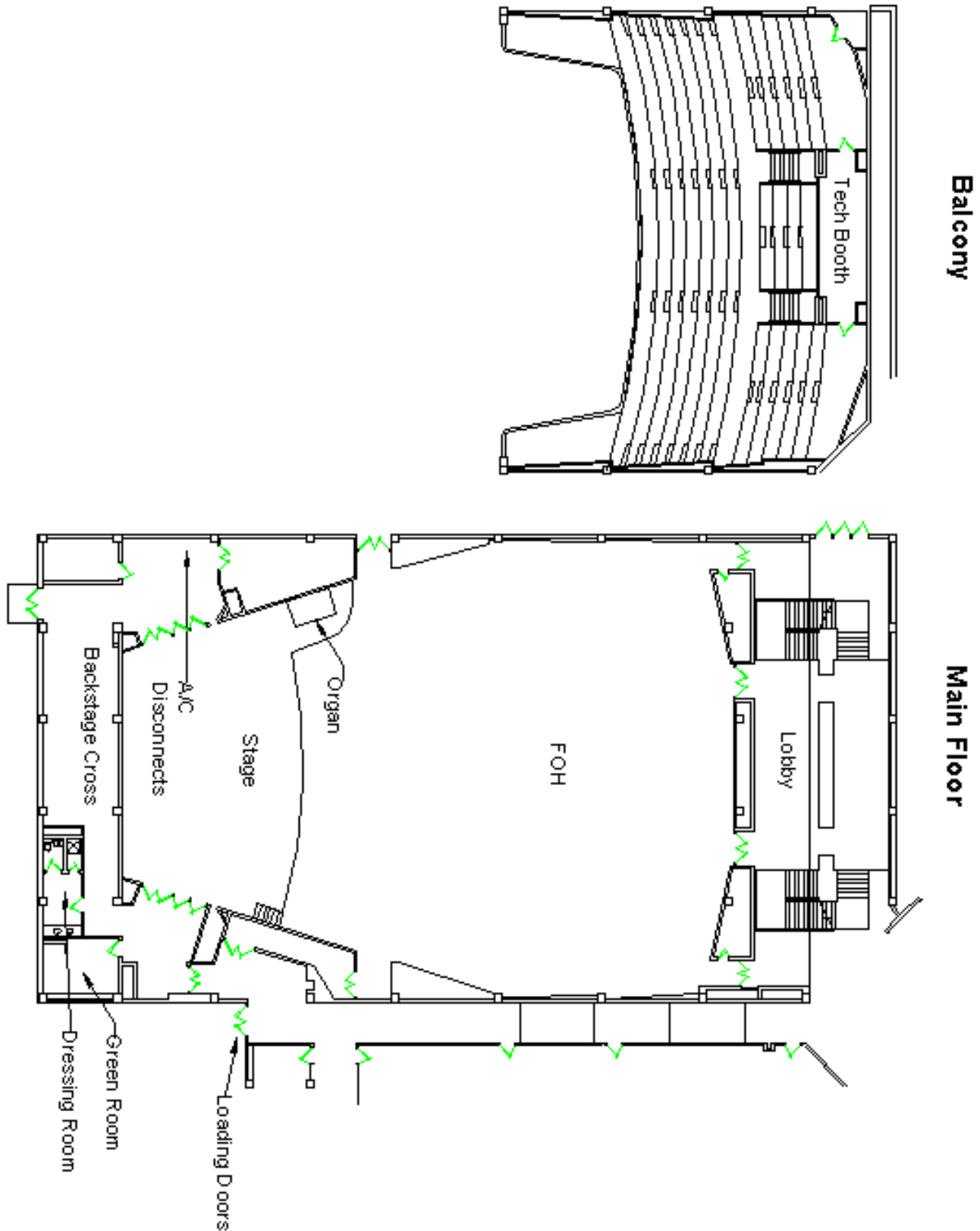

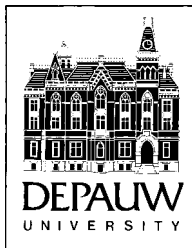

# Moore Theatre

[www.depauw.edu/pac](http://www.depauw.edu/pac)

## Technical Information

last revised: May 2002

(For further information, please contact Technical Director)

### **SYNOPSIS**

---

Moore Theatre is a fully-equipped proscenium theatre seating approximately 400. The space is best suited for stage plays, opera, and dance productions, but has also supported events such as music concerts, film projections, pageants, lectures, and meetings.

### **STAGE INFORMATION**

---

Type: Proscenium Stage

Floor: Hardwood floor covered in 1/4" masonite w/ black epoxy finish. The floor is flat with no unreasonable protrusions.

Width: Wall to Wall (with obstructions):	88'-8"	27.025 meters
Proscenium Opening:	56'-0"	17.068 meters
CS to S.R. dead masking:	29'-5 1/2"	8.978 meters
CS to S.L. dead masking:	28'-0"	8.534 meters
CS to S.R. wall (with obstruction):	42'-9 1/2"	13.042 meters
CS to S.L. wall (with obstruction):	45'-10 1/2"	13.982 meters

(Proscenium width can be closed to 36' with movable black tormentors just upstage of the arch)

Depth: Apron to Plaster Line:	4'-6"	1.371 meters
Plaster Line to back wall:	38'-3"	11.658 meters
Plaster Line to US blackout:	33'-8"	10.261 meters
US Crossover depth:	4'-5 1/2"	1.361 meters

Height: House Floor to Stage Floor:	app. 3'-2 1/2"	.978 meters
Proscenium:	20'	6.096 meters
Grid:	50'	15.24 meters

(Proscenium height can be closed with blue grand valance and/or black mechanized light bridge)

Pit: Location:	underneath and in front of apron	
Length:	36'-0"	10.972 meters
Depth:	14'-9"	4.495 meters
Pit Floor to House Floor:	5'-8 1/2"	1.740 meters
Pit Floor to Stage Floor:	9'-0"	2.743 meters
Access to Pit:	Basement corridor under the stage	

(Using the pit is *labor-intensive*. The pit floor can be decked up 31-3/4" inches with parallel platforms.)

Stage Drawings are available in AutoCad format or on request.

### **RIGGING:**

---

Pin Rail Location:	Against S.R. Wall		
Loading Platform:	Just below the grid		
Length of Battens:	56'		
Height of Arbors:	7'		
Brick weight:	28 lbs	12.7 kg	(half bricks also available)

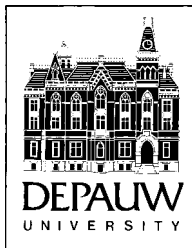

# Moore Theatre

[www.depauw.edu/pac](http://www.depauw.edu/pac)

## Technical Information

last revised: May 2002

(For further information, please contact Technical Director)

### LINESET SCHEDULE

Lineset	Distance	Usual Goods	Proposed Goods	Proposed Weight
	3'	Grand Valance		
	3'-8"	Grand Drape		
	4'-4" thru 7'	Motorized Electric Bridge		
1	7'-8"			
2	8'-4"			
3	9'			
4	9'-8"			
5	10'-4"	Border 1		
6	11'	Legs 1		
	11'-8"	First Electric		
7	12'-4"			
8	13'			
9	13'-8"			
10	14'-4"			
11	15'			
12	15'-8"			
13	16'-4"	Border 2		
14	17'	Legs 2		
	17'-8"	Second Electric		
		space, also intercom location		
15	19'-8"			
16	20'-4"			
17	21'			
18	21'-8"			
19	22'-4"			
20	23'	Border 3		
21	23'-8"	Legs 3		
	24'-4"	Third Electric		
22	25'			
23	25'-8"			
24	26'-4"			
25	27'			
26	27'-8"			
27	28'-4"	Border 4		
28	29'	Legs 4		
29	29'-8"	4th Electric		
30	30'-4"	Broken Arbor		
31	31'			
32	31'-8"			
		space		
33	33'	White Cyclorama		
34	33'-8"	Blackout Drop		
		space		
35	35'-8"			

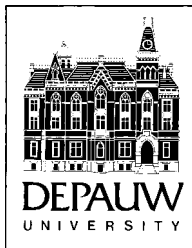

# Moore Theatre

[www.depauw.edu/pac](http://www.depauw.edu/pac)

## Technical Information

last revised: May 2002

(For further information, please contact Technical Director)

### GOODS

Quantity	Curtain	Width	Height	Description	Material
1	Main Drape	56' (17.07m)	24' (7.32m)	50% fullness	heavy blue velour
4	Leg Pairs	18' (5.49m)	26' (7.92m)	flat	black velour
4	Borders	84' (25.61m)	12' (3.66m)	flat	black velour
1	Bi-part blackout	56' *17.07m)	26' (7.92m)	50% fullness	black velour
1	Black Scrim	60' (18.29m)	25' (7.92m)		black sharkstooth
1	White Scrim	56' (17.07m)	25' (7.92m)		white sharkstooth
1	White Cyc	56' (17.07m)	25' (7.92m)		white canvas

### LOADING/UNLOADING

The loading doors are located PERPENDICULAR to the alley running on the north side of the building off of Locust Street. It is possible to back trucks 15 feet (4.57 meters) or shorter directly to the dock by doing a multi-point turn. Longer trucks will have to offload onto the ground and then lift up to the dock by hand. Thereafter, boxes are pushed through the scene shop onto stage through a LARGE mechanical shop door (located in the upstage wall).

Loading Door:

Usable Width:	5'-10"	1.78 meters
Usable Height:	7'-9"	2.36 meters
Dock Height:	2'-6"	.76 meters

### DRESSING ROOMS

The dressing rooms, makeup room, and costume shop are located in the corridor below the stage, accessed via the stairwell upstage of the S.L. wing or via an exterior stairwell near the loading dock. There is no elevator to that corridor. The green room is located upstage of the S.L. wing at stage level.

Women's Dressing Room:

Dimensions:	15'-2" x 20'-6"	4.62m x 6.25m	(changing area)
Amenities:	costume rack, mirrors		
Bathroom:	3 stalls, 3 sinks/mirrors, 2 showers		

Men's Dressing Room:

Dimensions:	15'-2" x 31'-5"	4.62m x 9.58m	(changing area)
Amenities:	costume rack, mirrors		
Bathroom:	1 stall, 2 urinals, 2 showers, 3 sinks/mirrors		

(continued on next page)

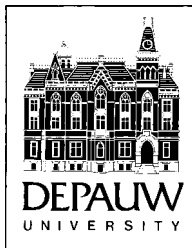

# Moore Theatre

[www.depauw.edu/pac](http://www.depauw.edu/pac)

## Technical Information

last revised: May 2002

(For further information, please contact Technical Director)

### ***DRESSING ROOMS (CONTINUED)***

**Green Room:**

Dimensions: 12'-5" x 20'      3.66m x 3.78m  
 Amenities: small refrigerator, range, oven, sink

**Costume Shop:**

Washing: washer, dryer, steamer, double washtub  
 Machines: serger, industrial sewing machine (machine use by permission only)

**Makeup Room:**

Dimensions: 12'-9" x 15'8"      3.89m x 4.78m  
 Counters (2): 15'-7" x 2'      4.75m x .61m  
 Mirrors (6): 5' x 3'      1.52m x .91m  
 Amenities: 6 wash basins, 6 mirrors with mirror lights, 6 duplex outlets

### ***CONTROL BOOTH***

The control booth is located in the center rear of the auditorium, up one level (accessed by stairs through the house left rear). It is separated into two sections. The larger of the two has a large window, houses the lighting console and is often used by the stage manager to call the show. The other section houses the sound console and equipment, and has a sliding glass window. Both sides boast audio stage monitors and clear-com ports (base station in the sound section). There is a ladder outside of the booth which provides one of the accesses to the FOH catwalk.

Distance from apron: approximately 50' (15.24 meters)

Other Balcony Equipment: Two Strong Roadie followpots

### ***LIGHTING***

Lighting Positions:	<u>From Plaster</u>	<u># of Circuits</u>
First Catwalk:	22'-6" (6.86m)	24
Second Catwalk:	40'-6" (12.34m)	24
Additional Catwalk:		4 house left & 4 house right <i>between</i> catwalks
Auxiliary Pipe:	13' (3.96m)	none, dead hung, accessed by genie from floor, labor-intensive
Box Booms (2):	3' (.91m)	6 each in the floor (20' vertical pipes on house side of proscenium)
Tormentors (2):	2'-6" (.76m)	6 each (vertical pipe on upstage side of tormentors)
Bridge (motorized):	6'-4" (1.93m)	24 + 2 works (each work circuit is two-fered along the pipe)
First Electric:	11'-8" (3.56m)	24 + 2 works (each work circuit is two-fered along the pipe)
Second Electric:	17'-8" (5.38m)	24 + 2 works (each work circuit is two-fered along the pipe)
Third Electric:	24'-4" (7.42m)	24 + 2 works (each work circuit is two-fered along the pipe)
Fourth Electric:	29'-8" (9.04m)	24 + 2 works (each work circuit is two-fered along the pipe)
Additional Stage:		30 (3-circuit floor pockets, three in each wing, four across upstage wall)
Dimmers:	288 ETC Sensor 2.4Kw	
Patch:	Only soft patch, otherwise dimmer/circuit	
Console:	ETC Expression 3 (two monitors) with Remote Focus Unit	
Plugs:	All plugs are 2P&G connectors (except Stick-Ups, which are Edison)	
Focusing:	Genie PLC-24 Personnel Lift Pipes fly to 4' above stage floor	

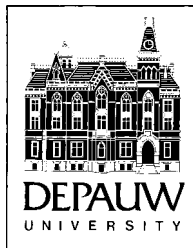

# Moore Theatre

[www.depauw.edu/pac](http://www.depauw.edu/pac)

## Technical Information

last revised: May 2002

(For further information, please contact Technical Director)

### **LIGHTING INVENTORY**

---

<u>Quantity</u>	<u>Make</u>	<u>Model</u>	<u>Beam</u>	<u>Wattage</u>	<u>Lamp</u>
11	ETC	Source Four	19	575W	HPL
41	ETC	Source Four	26	575W	HPL
19	ETC	Source Four	36	575W	HPL
18	ETC	Source Four	50	575W	HPL
(please note there are 10 less instruments than above barrels)					
42	Altman	6" Fresnel		1000W	
30	Altman	6" Fresnel	older	500W	
10		PAR64	various	1000W	
app. 10	Altman	Ellipsoidal	6 x 9	500W-750W	
app. 6	Altman	Ellipsoidal	6 x 16	500W-1000W	
4 quads	Altman	SkyCyc4		1000W	
8	Altman	Focusing Cyc		1000W	
12		14" Scoops			
1	Colortran				
5	Altman	Q-Lights	(used as works over stage)		
6		Stick-ups			
4		Running Lights			
2		Variable Focus			
4		4½" minis			
2	Strong	Roadie follow spots			

### **SOUND**

---

Moore Theatre is acoustically live enough to perform unaccompanied productions without sound reinforcement. The in-house system is adequate for playback, but no microphones are available except by special arrangement. DePauw utilizes several sound subcontractors when necessary, but prefers not to do so unless circumstances require it.

### **SOUND INVENTORY**

---

- 1 Mackie CFX-12 Mixing Console, on-board effects, 8 mono mic/line in, 2 stereo line in, 4 sub outs, 2 aux sends
- 4 Mackie M-1400 power amps, patchable to 11 jacks throughout house and stage
- 1 Teac CD-P1440 single tray CD Player
- 1 Tascam CD-A500 CD/Cassette combo deck
- 2 ADC III 24-chan patch panels (mic lines and playback outputs to mixer inputs, mixer outputs to amp inputs)
- 2 older JBL full-range speakers in rolling cabinets
- 2 Tannoy speakers (used as effects speakers)
- 4 balanced circuits from back of each proscenium to the booth (eight lines total)  
all mics, stands, monitors, etc. must be rented or imported from other halls.

### **INTERCOM**

---

- 1 Stage monitor system feeding green room, dressing rooms, makeup rooms, etc., with talk mic in sound booth
- 1 Clear-comm intercom base station
- 7 belt-pack/headset combos normally in theatre, can scavenge from other halls if more are needed
- 10 intercom jacks throughout backstage, pit, house, booth, and balcony

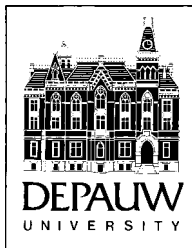

# Moore Theatre

[www.depauw.edu/pac](http://www.depauw.edu/pac)

## Technical Information

last revised: May 2002

(For further information, please contact Technical Director)

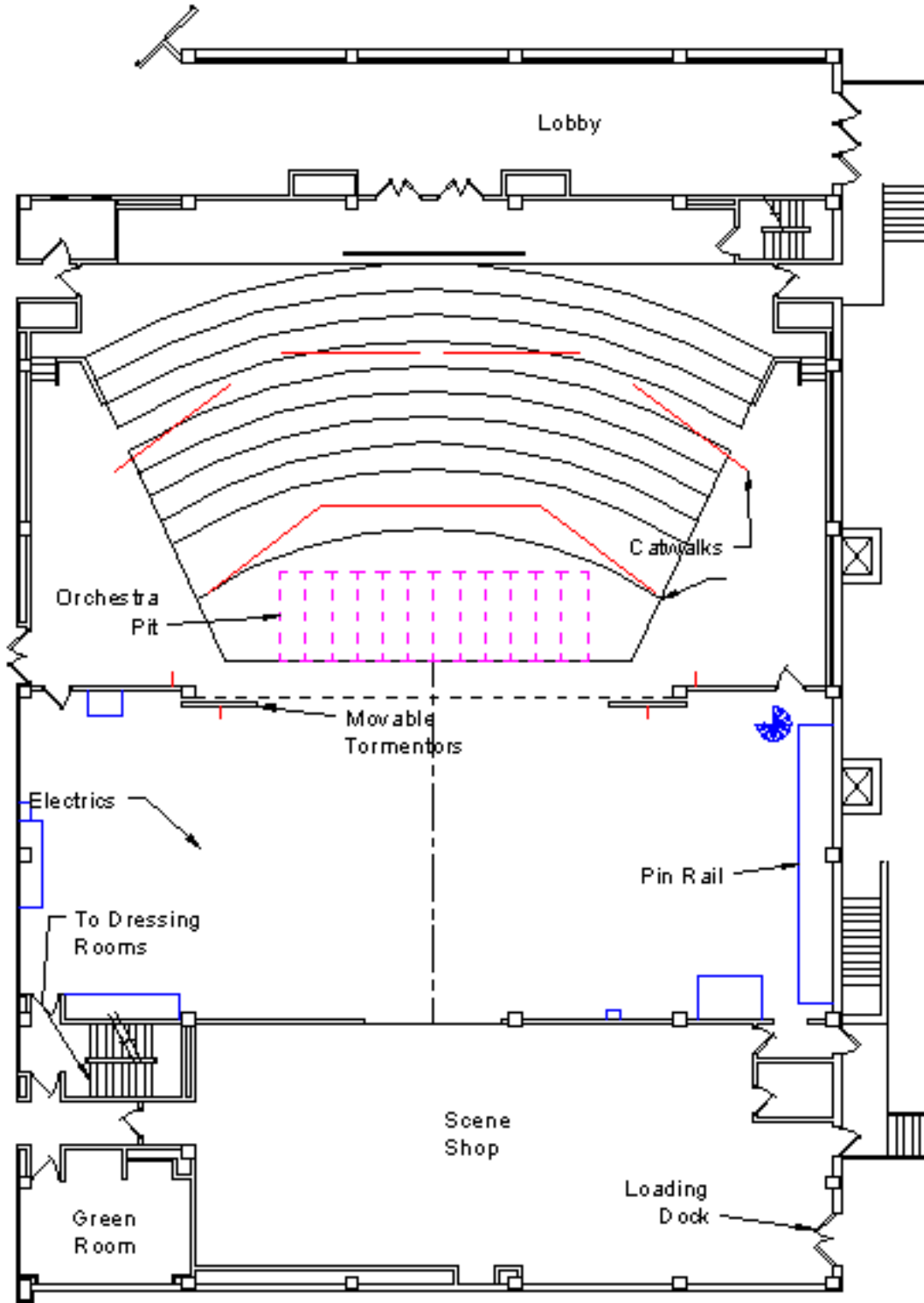

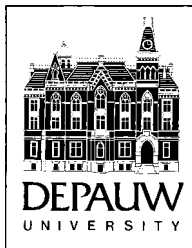

# Thompson Recital Hall

[www.depauw.edu/pac](http://www.depauw.edu/pac)

## Technical Information

last revised: Sept 2002

(For further information, please contact Technical Director)

### **SYNOPSIS**

---

Thompson Recital Hall serves as the primary venue for School of Music recitals and chamber concerts, as well as being an intimate venue for visiting artists and lecturers. This acoustically live hall requires no sound reinforcement, although some lecturers prefer using the in-house PA. The seating capacity for this hall is 219.

### **STAGE INFORMATION**

---

Type:	Concert Hall (no proscenium or fly space)	
Floor:	Hardwood floor stained blonde and finished with clear polyurethane	
Width:	Wall to Wall (upstage):	14'-2"                      4.305 meters
	Wall to Wall (downstage):	32'-3"                      9.830 meters
	(permanent organ obstruction downstage left - see drawings)	
Depth:	Apron to upstage wall:	17'-10"                      5.433 meters
Height:	House Floor to Stage Floor:	3'-3"                              .991 meters
	Stage Floor to ceiling:	20'                                6.096 meters

Stage Drawings are available in AutoCad format or on request.

### **LOADING/UNLOADING**

---

The loading doors for this hall are located off an inclined paved drive off of Olive Street. They are standard double doors with a removable center post. All gear must be pushed through THREE sets of double doors to reach the stage (outer doors, backstage doors, and onstage doors).

Usable Width:	5'-10"	1.78 meters
Usable Height:	7'-9"	2.36 meters

### **DRESSING ROOMS**

---

There is one dressing room and one green room only, as follows:

#### Dressing Room:

Dimensions:	10'-5" x 8'	3.20m x 2.44m
Amenities:	costume rack, mirrors, counterspace, 2 sinks	
Bathroom:	1 commode, 1 shower	

#### Backstage Area/Green Room:

Dimensions:	11'-10" x 37'	3.62m x 11.28m
-------------	---------------	----------------

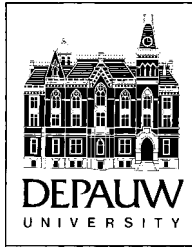

# Thompson Recital Hall

[www.depauw.edu/pac](http://www.depauw.edu/pac)

## Technical Information

last revised: Sept 2002

(For further information, please contact Technical Director)

### **LIGHTING**

---

The hall supports concert lighting only, with 18 ETC SourceFour Pars hung from the house ceiling as front light (fixed focus), and incandescent down light over the stage. The lighting system is controlled with a Unison touch screen panel located backstage. The standard presets are:

House:	Includes house and overhead stage
House 1/2:	Takes house lights to half
Recital:	Brings up concert lighting

There are four other available presets for customization if necessary. Also, there are several 2P&G dimmable circuits located in floor pockets on stage and in several places throughout the auditorium.

Dimmers:	288 ETC Sensor 2.4Kw
Patch:	Only soft patch, otherwise dimmer/circuit
Console:	Unison Architectural control system
Plugs:	All plugs are 2P&G connectors

### **SOUND**

---

- 1 seven-channel rackmount mixer, used mainly for recording
- 1 Sony PCM-R500 DAT recorder
- 1 Tascam 112 mkII cassette recorder
- 2 Audio-Technica 7000 series wireless systems (each with either handheld or belt-pack)
- 1 Old JBL 70V ceiling PA system

(Any other sound equipment must be rented and/or imported from other halls)

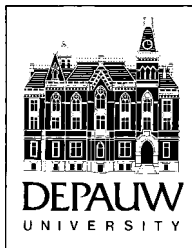

# Thompson Recital Hall

[www.depauw.edu/pac](http://www.depauw.edu/pac)

## Technical Information

last revised: Sept 2002

(For further information, please contact Technical Director)

